



Royal Drive, Friern Barnet, N11 3FL
Guide Price £850,000 Leasehold

Council Tax Band G

REAL ESTATES
Est. 1981

Estate Agents · Residential Sales · Investments · Lettings

* CHAIN FREE SALE * Real Estates are pleased to bring to the market this substantial THREE BEDROOM TWO BATHROOM DUPLEX APARTMENT, totalling over 1800 square feet, set in the prestigious Princess Park Manor in Friern Barnet.

Perfect for families and downsizers, and located within a gated security controlled development, this property benefits from a PRIVATE FIRST FLOOR TERRACE, a principal bedroom with fitted wardrobes and EN-SUITE BATHROOM, multiple reception rooms including a lounge with DOUBLE HEIGHT CEILINGS, sash windows throughout, and a separate eat-in kitchen featuring the original Friern Hospital corridor brick roof.

There is an ALLOCATED PARKING SPACE directly outside the entrance to the building, plus access to the park opposite with its open green space and tennis courts. There is a Nuffield Health Gym on site as well as plenty of visitor parking. New Southgate Station is within easy reach, providing a speedy route into the City of London, whilst there are shops and amenities in nearby Friern Barnet or Arnos Grove.

SOLE AGENT





Princess Park Manor, Royal Drive, London, N11



Approximate Area = 1811 sq ft / 168.2 sq m
Limited Use Area(s) = 24 sq ft / 2.2 sq m
Total = 1835 sq ft / 170.4 sq m

For identification only - Not to scale

Denotes restricted head height

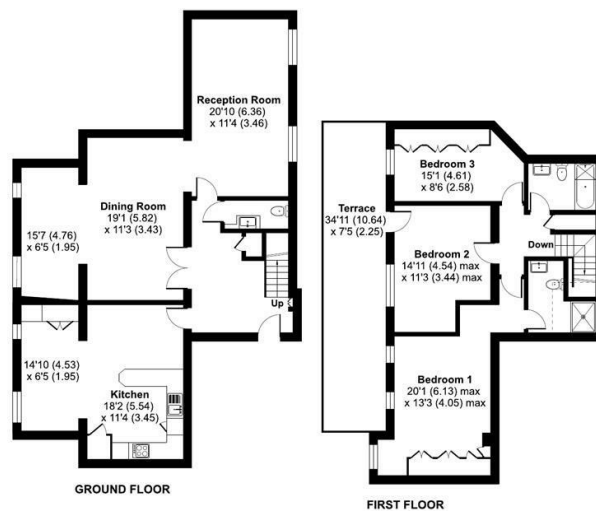

Floor plan produced in accordance with RICS Property Measurement 2nd Edition, incorporating International Property Measurement Standards (IPMS2 Residential). © richcom 2025. Produced for Real Estates. REF: 1408602

Energy Efficiency Rating		
	Current	Potential
Very energy efficient - lower running costs		
A		
B		
C	77	77
D		
E		
F		
G		
Not energy efficient - higher running costs		
EU Directive		



Real Estates Woodside Park Office:
14/14a Sussex Ring
Woodside Park N12 7HX

ll : 020 8445 6387
e : info@realestates-wsp.co.uk
w : www.realestates-wsp.co.uk